

# CARTEC

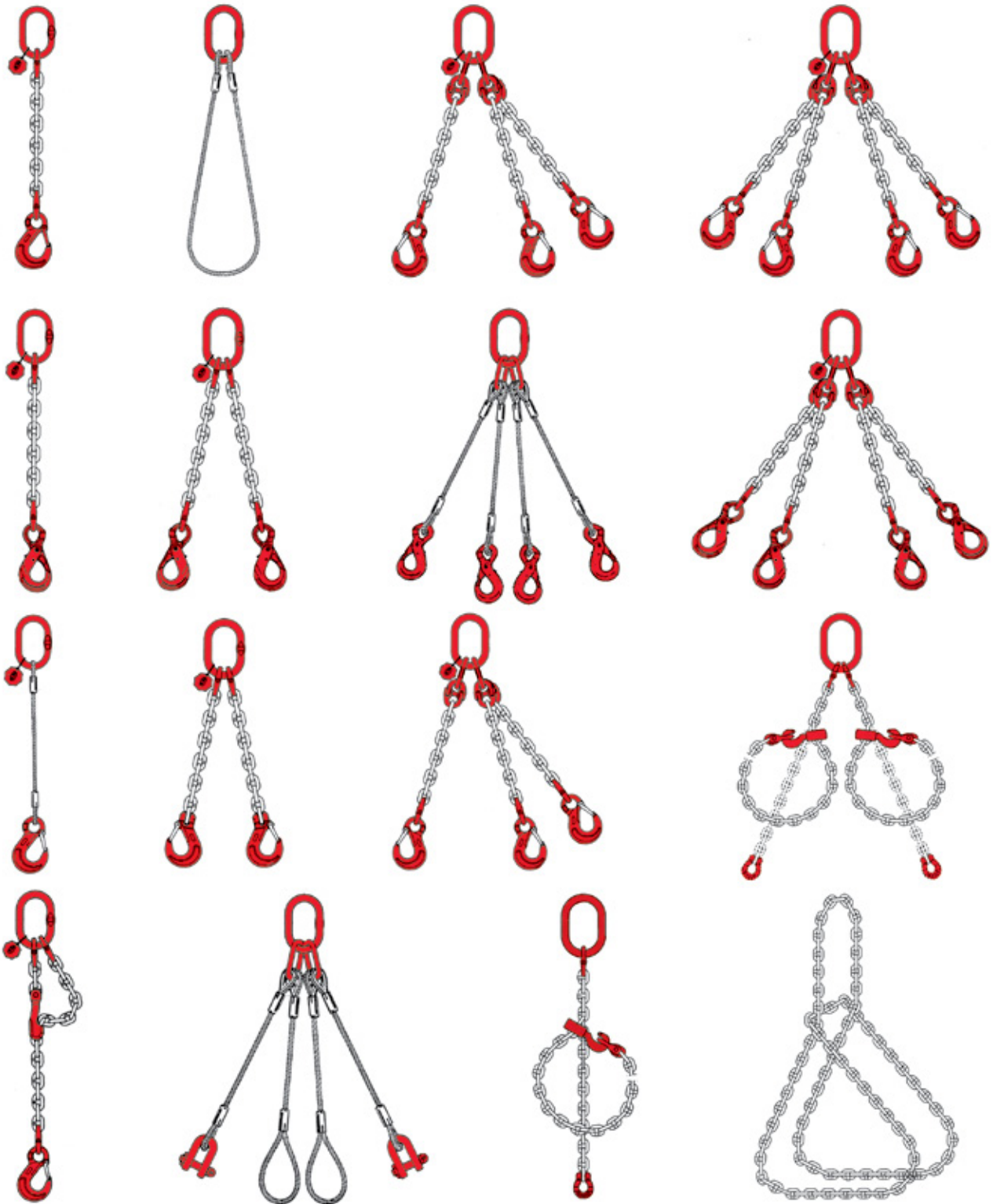

ACCESSORI GRADO 80  
ACCESSORIES GRADE 80  
ACCESSOIRES GRADE 80  
GRAD-80 ZUBEHÖRE

ESEMPI DI UTILIZZO DEGLI ACCESSORI "LINEA CARTEC" PER LA COSTRUZIONE DI IMBRAGHE PER SOLLEVAMENTO.  
EXAMPLES OF USE OF "LINEA CARTEC" ACCESSORIES FOR THE CONSTRUCTION OF LIFTING SLINGS  
EXEMPLES D'UTILIZATION DES ACCESSOIRES "LINEA CARTEC" POUR LA CONSTRUCTION DES ELINGUES DE LEVAGE  
BEISPIELE VON BENUTZUNG DER ZUBEHÖREN "LINEA CARTEC" FÜR DIE BAU VON HEBESCHLINGEN



## SCHEMA SINOTTICO PER LA FORMAZIONE DI IMBRAGHE CON ACCESSORI "CARTEC"

ASSEMBLY CAPABILITY BETWEEN THE COMPONENTS OF SLING

POSSIBILITE DE CONNEXION ENTRE LES ELEMENTS DE L'ELINGUE

VERBINDUNGS MÖGLICHKEITEN BEI ANSCHLAGKETTEN



Connessione catena-accessorio mediante:  
Connection chain-fitting by means of:  
Connexion chaîne-accessoire au moyen de:  
Verbindung Kette - Zubehörteil mittels:

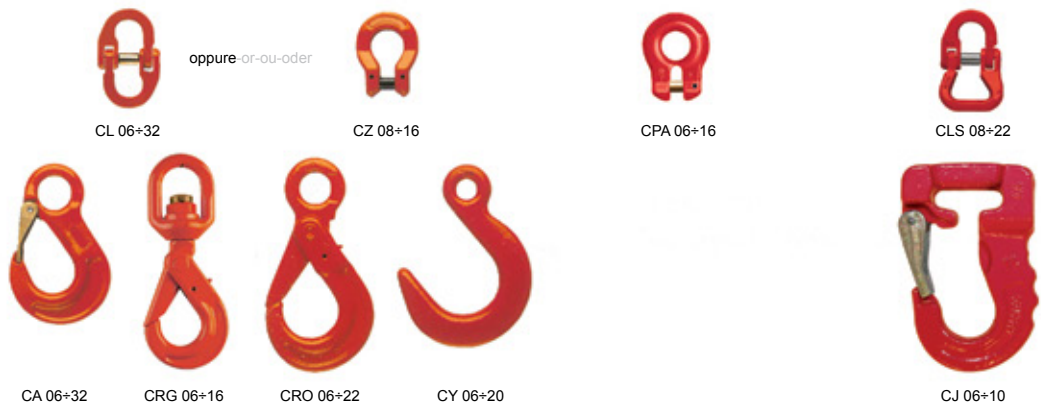

## SCHEDA DI CONNESSIONE TRA GLI ACCESSORI "CARTEC"

CONNECTION BETWEEN THE COMPONENTS OF SLINGS

CONNEXION ENTRE LES ELEMENTS DE L'ELINGUE

VERBINDUNG ZWISCHEN DIE BAUELEMENTE VON ANSCHLAGKETTEN



| Catena<br>Chain<br>Chaîne<br>Kette |       | Imbraghe ad un tratto<br>Single slings<br>Elingue simple<br>1 Strängige Anschlagkette |         | Imbraghe a due tratti<br>Double slings<br>Elingue double<br>2 Strängige Anschlagketten |         | Imbraghe a tre o quattro tratti<br>Triple or quadruple slings<br>Elingue triple ou quadruple<br>3-4 Strängige Anschlagketten |        | Codice<br>Code<br>Code<br>Code |       |        |       |        |       |  |  |
|------------------------------------|-------|---|---------|--|---------|--|--------|--------------------------------|-------|--------|-------|--------|-------|--|--|
| Ømm                                | inch  |   |         |  |         |  |        |                                |       |        |       |        |       |  |  |
| 6                                  | 1/4   | CM 0706   | CN 0807 | CM 0706  | CN 0807 | CMC 06   | CNC 07 | CL 06                          | -     | CPA 06 | CX 06 | CX 06S | CD 06 |  |  |
| 7                                  | 9/32  | CM 0706   | CN 0807 | CM 0807  | CN 0807 | CMC 07   | CNC 07 | CL 07                          | CZ 08 | -      | CX 07 | CX 07S | CD 08 |  |  |
| 8                                  | 5/16  | CM 0807   | CN 0807 | CM 1008  | CN 1008 | CMC 08   | CNC 08 | CL 08                          | CZ 08 | CPA 08 | CX 08 | CX 08S | CD 08 |  |  |
| 10                                 | 3/8   | CM 1008   | CN 1008 | CM 1310  | CN 1310 | CMC 10   | CNC 10 | CL 10                          | CZ 10 | CPA 10 | CX 10 | CX 10S | CD 10 |  |  |
| 13                                 | 1/2   | CM 1310   | CN 1310 | CM 1613  | CN 1613 | CMC 13   | CNC 13 | CL 13                          | CZ 13 | CPA 13 | CX 13 | CX 13S | CD 13 |  |  |
| 16                                 | 5/8   | CM 1613   | CN 1613 | CM 1816  | CN 2016 | CMC 16   | CNC 16 | CL 16                          | CZ 16 | CPA 16 | CX 16 | CX 16S | CD 16 |  |  |
| 20                                 | 3/4   | CM 2018   | CN 2016 | CM 2220  | CN 2220 | CMC 20   | CNC 20 | CL 20                          | -     | -      | -     | -      | CD 20 |  |  |
| 22                                 | 7/8   | CM 2220   | CN 2220 | CM 2622  | CN 2622 | CMC 22   | CNC 22 | CL 22                          | -     | -      | -     | -      | CD 22 |  |  |
| 26                                 | 1     | CM 2622   | CN 2622 | CM 3226  | CN 3226 | CMC 26   | CNC 26 | CL 26                          | -     | -      | -     | -      | CD 26 |  |  |
| 32                                 | 1 1/4 | CM 3226   | CN 3226 | CM 3632  | CN 3632 | CMC 32   | CNC 32 | CL 32                          | -     | -      | -     | -      | -     |  |  |

**Connessione anellone-catena mediante:**  
 Connection Masterlink-chain by means of:  
 Connexion maille de tête-chaîne au moyen de:  
 Verbindung Aufhängering-Kette mittels:



**Accorciatori**  
 Shortening hooks  
 Crochets de raccourcissement  
 Verkürzungsklauen

**Connessione diretta catena-accessorio**  
 Direct connection chain-fitting  
 Connexion directe chaîne-accessoire  
 Direkte Verbindung Kette - Zubehörteil

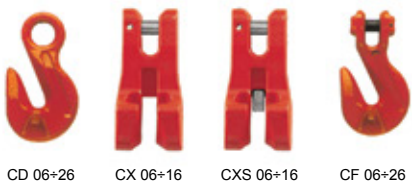

**Usi speciali**  
 Special uses  
 Usages spéciaux  
 Besondere Verwendungen

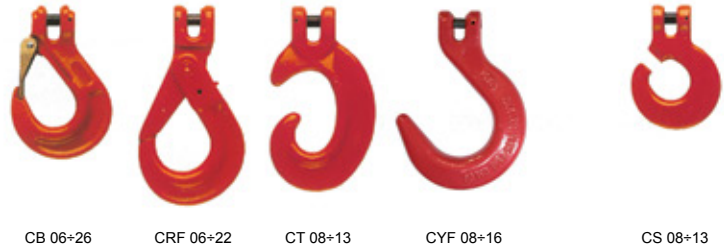

**USI SPECIALI**  
 SPECIAL USES  
 USAGES SPECIAUX  
 BESONDERE VERWENDUNGEN



**Codice**  
 Code  
 Code  
 Code

**Catena**  
 Chain  
 Chaîne  
 Kette

**Codice**  
 Code  
 Code  
 Code

|       |       |        |        |       |       |        |       |        | Ømm   |    | inch  |        |  |  |  |       |
|-------|-------|--------|--------|-------|-------|--------|-------|--------|-------|----|-------|--------|--|--|--|-------|
| CF 06 | CA 06 | CRG 06 | CRO 06 | CY 06 | CB 06 | CRF 06 | -     | CYF 06 | -     | 6  | 1/4   | -      |  |  |  |       |
| CF 08 | CA 08 | CRG 08 | CRO 08 | CY 08 | CB 08 | CRF 08 | CT 08 | CYF 07 | CS 08 | 7  | 9/32  | CLS 08 |  |  |  | CJ 01 |
| CF 08 | CA 08 | CRG 08 | CRO 08 | CY 08 | CB 08 | CRF 08 | CT 08 | CYF 08 | CS 08 | 8  | 5/16  | -      |  |  |  | CJ 02 |
| CF 10 | CA 10 | CRG 10 | CRO 10 | CY 10 | CB 10 | CRF 10 | CT 10 | CYF 12 | CS 10 | 10 | 3/8   | CLS 10 |  |  |  | CJ 03 |
| CF 13 | CA 13 | CRG 13 | CRO 13 | CY 13 | CB 13 | CRF 13 | CT 13 | CYF 13 | CS 13 | 13 | 1/2   | CLS 13 |  |  |  | CJ 04 |
| CF 16 | CA 16 | CRG 16 | CRO 16 | CY 16 | CB 16 | CRF 16 | -     | CYF 16 | -     | 16 | 5/8   | CLS 16 |  |  |  | CJ 05 |
| CF 20 | CA 20 | -      | CRO 20 | CY 20 | CB 20 | CRF 20 | -     | -      | -     | 20 | 3/4   | CLS 20 |  |  |  | CJ 06 |
| CF 22 | CA 22 | -      | CRO 22 | -     | CB 22 | CRF 22 | -     | -      | -     | 22 | 7/8   | CLS 22 |  |  |  | CJ 08 |
| CF 26 | CA 26 | -      | -      | -     | CB 26 | -      | -     | -      | -     | 26 | 1     | -      |  |  |  | -     |
| -     | CA 32 | -      | -      | -     | -     | -      | -     | -      | -     | 32 | 1 1/4 | -      |  |  |  | -     |



**CL**

**MAGLIA DI CONNESSIONE CARTEC**  
**CARTEC CONNECTING LINK**  
**MAILLON DE JONCTION CARTEC**  
**VERBINDUNGSGLIED CARTEC**

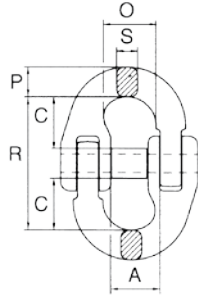

| Catena<br>Chain<br>Chaîne<br>Kette |       | Codice<br>Code<br>Code<br>Code | A    | C    | O    | R    | P    | S    | Peso<br>Weight<br>Poids<br>Gewicht | W.L.L. |
|------------------------------------|-------|--------------------------------|------|------|------|------|------|------|------------------------------------|--------|
| mm                                 | inch  |                                | mm   | mm   | mm   | mm   | mm   | mm   | Kg                                 | Kg     |
| 6                                  | 1/4   | CL 06                          | 16   | 18   | 16,5 | 43   | 7,2  | 6,8  | 0,07                               | 1120   |
| 7                                  | 9/32  | CL 07                          | 17,8 | 20   | 20,5 | 50,5 | 10,2 | 9    | 0,10                               | 1500   |
| 8                                  | 5/16  | CL 08                          | 19   | 25,5 | 23,5 | 62   | 11,5 | 10   | 0,25                               | 2000   |
| 10                                 | 3/8   | CL 10                          | 23,8 | 30   | 27,5 | 72   | 12,6 | 12,6 | 0,35                               | 3150   |
| 13                                 | 1/2   | CL 13                          | 28   | 36   | 33,3 | 87,3 | 19   | 16,7 | 0,68                               | 5300   |
| 16                                 | 5/8   | CL 16                          | 34,3 | 40,5 | 39,5 | 103  | 20,6 | 20,6 | 1,10                               | 8000   |
| 20                                 | 3/4   | CL 20                          | 44   | 48   | 47   | 116  | 23   | 23   | 1,70                               | 12500  |
| 22                                 | 7/8   | CL 22                          | 49   | 51   | 55   | 133  | 26,5 | 26,5 | 2,20                               | 15000  |
| 26                                 | 1     | CL 26                          | 60   | 60   | 66   | 148  | 31,5 | 31,5 | 4,20                               | 21200  |
| 32                                 | 1 1/4 | CL 32                          | 80   | 77   | 86   | 190  | 40   | 32   | 7,19                               | 31500  |

**CLS**

**SAGOLA PER NASTRI**  
**WEBBING COUPLING LINK**  
**MAILLE D'ACCOUPEMENT POUR SANGLE**  
**RUNDSCHLINGEN-KUPPLUNG FÜR BÄNDER**

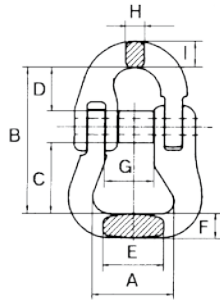

| Catena<br>Chain<br>Chaîne<br>Kette |           | Codice<br>Code<br>Code<br>Code | A   | B   | C   | D  | E  | F  | G  | H  | I  | Peso<br>Weight<br>Poids<br>Gewicht | W.L.L. |
|------------------------------------|-----------|--------------------------------|-----|-----|-----|----|----|----|----|----|----|------------------------------------|--------|
| mm                                 | inch      |                                | mm  | mm  | mm  | mm | mm | mm | mm | mm | mm | Kg                                 | Kg     |
| 7-8                                | 9/32-5/16 | CLS 08                         | 40  | 58  | 24  | 20 | 24 | 14 | 17 | 9  | 10 | 0,28                               | 2000   |
| 10                                 | 3/8       | CLS 10                         | 40  | 81  | 35  | 30 | 30 | 14 | 23 | 11 | 13 | 0,47                               | 3150   |
| 13                                 | 1/2       | CLS 13                         | 55  | 104 | 48  | 36 | 36 | 18 | 28 | 16 | 16 | 0,99                               | 5300   |
| 16                                 | 5/8       | CLS 16                         | 67  | 115 | 57  | 40 | 44 | 24 | 36 | 21 | 21 | 2,0                                | 8000   |
| 20                                 | 3/4       | CLS 20                         | 82  | 134 | 65  | 50 | 52 | 29 | 40 | 23 | 23 | 2,3                                | 12500  |
| 22                                 | 7/8       | CLS 22                         | 125 | 177 | 100 | 59 | 68 | 39 | 43 | 27 | 27 | 6,3                                | 15000  |

**CZ**

**ANELLO A OMEGA**  
**OMEGA SHACKLE**  
**COUPLER OMEGA**  
**VERBINDUNGSBÜGEL OMEGA**

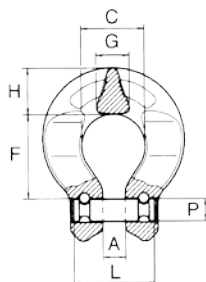

| Catena<br>Chain<br>Chaîne<br>Kette |           | Codice<br>Code<br>Code<br>Code | A    | C  | F  | G  | H  | PxL       | Peso<br>Weight<br>Poids<br>Gewicht | W.L.L. |
|------------------------------------|-----------|--------------------------------|------|----|----|----|----|-----------|------------------------------------|--------|
| mm                                 | inch      |                                | mm   | mm | mm | mm | mm | mm        | Kg                                 | Kg     |
| 7-8                                | 9/32-5/16 | CZ 08                          | 8,7  | 24 | 32 | 11 | 18 | 9,5x33,5  | 0,18                               | 2000   |
| 10                                 | 3/8       | CZ10                           | 12,5 | 32 | 44 | 14 | 19 | 13,0x43,5 | 0,35                               | 3150   |
| 13                                 | 1/2       | CZ 13                          | 15   | 40 | 55 | 17 | 25 | 17,0x57,0 | 0,72                               | 5300   |
| 16                                 | 5/8       | CZ 16                          | 19   | 50 | 65 | 22 | 30 | 21,0x69,0 | 1,20                               | 8000   |

## CPA

**ATTACCO A FORCELLA**  
CLEVIS ATTACHMENTS  
ATTACHE À CHAPE  
GABELVERBINDER

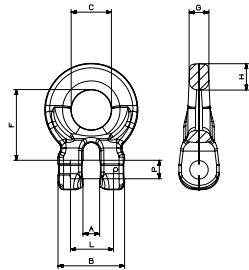

| Catena<br>Chain<br>Chaîne<br>Kette |      | Codice<br>Code<br>Code<br>Code | A    | B  | C  | F    | G    | H    | PxL     | Peso<br>Weight<br>Poids<br>Gewicht | W.L.L. |
|------------------------------------|------|--------------------------------|------|----|----|------|------|------|---------|------------------------------------|--------|
| mm                                 | inch |                                | mm   | mm | mm | mm   | mm   | mm   | mm      | Kg                                 | Kg     |
| 6                                  | 1/4  | CPA 06                         | 7,5  | 32 | 18 | 32   | 9,8  | 11   | 7,5x21  | 0,15                               | 1120   |
| 8                                  | 5/16 | CPA 08                         | 9,5  | 40 | 24 | 42,5 | 12   | 15   | 9x26    | 0,28                               | 2000   |
| 10                                 | 3/8  | CPA 10                         | 12   | 48 | 30 | 51,5 | 15,7 | 18   | 13x31,5 | 0,5                                | 3150   |
| 13                                 | 1/2  | CPA 13                         | 15,5 | 54 | 36 | 63,5 | 19   | 21,5 | 16x42   | 0,9                                | 5300   |
| 16                                 | 5/8  | CPA 16                         | 18   | 70 | 47 | 79,5 | 22,7 | 27,5 | 21x51,5 | 1,8                                | 8000   |

## CX

**ACCORCIATORE**  
SHORTENING CLUTCH  
GRIFFE DE RACCOURCISSEMENT  
VERKÜRZUNGSKLAUE

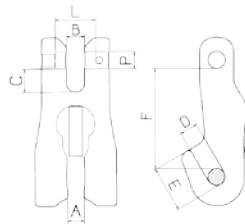

| Catena<br>Chain<br>Chaîne<br>Kette |      | Codice<br>Code<br>Code<br>Code | A    | B    | C    | D    | E    | F   | PxL      | Peso<br>Weight<br>Poids<br>Gewicht | W.L.L. |
|------------------------------------|------|--------------------------------|------|------|------|------|------|-----|----------|------------------------------------|--------|
| mm                                 | inch |                                | mm   | mm   | mm   | mm   | mm   | mm  | mm       | Kg                                 | Kg     |
| 6                                  | 1/4  | CX 06                          | 8    | 8    | 10   | 8    | 19   | 45  | 7,5x17,5 | 0,21                               | 1120   |
| 7                                  | 9/32 | CX 07                          | 9,5  | 9,5  | 10   | 9,5  | 23,5 | 56  | 9x22,5   | 0,48                               | 1500   |
| 8                                  | 5/16 | CX 08                          | 9,5  | 9,5  | 10   | 9,5  | 23,5 | 56  | 10x22,5  | 0,48                               | 2000   |
| 10                                 | 3/8  | CX 10                          | 12   | 12   | 14,5 | 12   | 32,5 | 78  | 13x31,5  | 1,12                               | 3150   |
| 13                                 | 1/2  | CX 13                          | 15,5 | 15,5 | 18   | 15,5 | 44   | 90  | 16x42    | 1,83                               | 5300   |
| 16                                 | 5/8  | CX 16                          | 19   | 21   | 21   | 19   | 50   | 106 | 21x51,5  | 2,83                               | 8000   |

## CX S

**ACCORCIATORE CON SICURA**  
SHORTENING CLUTCH WITH SAFETY  
GRIFFE DE RACCOURCISSEMENT  
VERKÜRZUNGSKLAUE MIT SICHERUNG

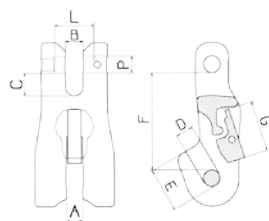

| Catena<br>Chain<br>Chaîne<br>Kette |      | Codice<br>Code<br>Code<br>Code | A    | B    | C    | D    | E    | F   | G  | PxL      | Peso<br>Weight<br>Poids<br>Gewicht | W.L.L. |
|------------------------------------|------|--------------------------------|------|------|------|------|------|-----|----|----------|------------------------------------|--------|
| mm                                 | inch |                                | mm   | mm   | mm   | mm   | mm   | mm  | mm | mm       | Kg                                 | Kg     |
| 6                                  | 1/4  | CX 06S                         | 8    | 8    | 10   | 8    | 19   | 45  | 23 | 7,5x17,5 | 0,21                               | 1120   |
| 7                                  | 9/32 | CX 07S                         | 9,5  | 9,5  | 10   | 9,5  | 23,5 | 56  | 29 | 9x22,5   | 0,48                               | 1500   |
| 8                                  | 5/16 | CX 08S                         | 9,5  | 9,5  | 10   | 9,5  | 23,5 | 56  | 29 | 10x22,5  | 0,48                               | 2000   |
| 10                                 | 3/8  | CX 10S                         | 12   | 12   | 14,5 | 12   | 32,5 | 78  | 36 | 13x31,5  | 1,12                               | 3150   |
| 13                                 | 1/2  | CX 13S                         | 15,5 | 15,5 | 18   | 15,5 | 44   | 90  | 35 | 16x42    | 1,83                               | 5300   |
| 16                                 | 5/8  | CX 16S                         | 19   | 21   | 21   | 19   | 50   | 106 | 38 | 21x51,5  | 2,83                               | 8000   |

**CD**

**GANCIO ACCORCIATORE AD OCCHIO**  
**EYE GRAB HOOK**  
**CROCHET DE RACCOURCISSEMENT À OEIL**  
**VERKÜRZUNGSHAKEN MIT ÖSE**

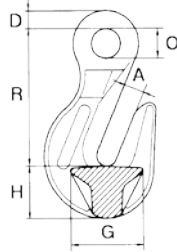

| Catena<br>Chain<br>Chaîne<br>Kette |           | Codice<br>Code<br>Code<br>Code | A    | D   | G   | H  | O    | R    | Peso<br>Weight<br>Poids<br>Gewicht | W.L.L. |
|------------------------------------|-----------|--------------------------------|------|-----|-----|----|------|------|------------------------------------|--------|
| mm                                 | inch      |                                | mm   | mm  | mm  | mm | mm   | mm   |                                    |        |
| 6                                  | 1/4       | CD 06                          | 8    | 8,5 | 22  | 22 | 13,5 | 53,5 | 0,18                               | 1120   |
| 7-8                                | 9/32-5/16 | CD 08                          | 10   | 10  | 30  | 24 | 16   | 60   | 0,23                               | 2000   |
| 10                                 | 3/8       | CD 10                          | 13   | 11  | 44  | 31 | 21   | 80   | 0,59                               | 3150   |
| 13                                 | 1/2       | CD 13                          | 17   | 16  | 53  | 38 | 26   | 104  | 1,24                               | 5300   |
| 16                                 | 5/8       | CD 16                          | 20   | 19  | 64  | 60 | 30   | 129  | 2,6                                | 8000   |
| 20                                 | 3/4       | CD 20                          | 23   | 22  | 85  | 65 | 36   | 153  | 4,2                                | 12500  |
| 22                                 | 7/8       | CD 22                          | 26   | 30  | 87  | 71 | 42   | 184  | 5,35                               | 15000  |
| 26                                 | 1         | CD 26                          | 30,5 | 36  | 100 | 90 | 55   | 213  | 13                                 | 21200  |

**CF**

**GANCIO ACCORCIATORE A FORCELLA**  
**CLEVIS GRAB HOOK**  
**CROCHET DE RACCOURCISSEMENT À CHAPE**  
**VERKÜRZUNGSHAKEN MIT GABEL**

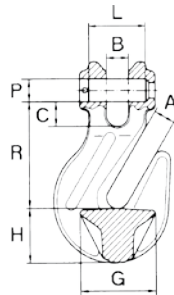

| Catena<br>Chain<br>Chaîne<br>Kette |           | Codice<br>Code<br>Code<br>Code | A    | B  | C   | G   | H  | R     | PxL      | Peso<br>Weight<br>Poids<br>Gewicht | W.L.L. |
|------------------------------------|-----------|--------------------------------|------|----|-----|-----|----|-------|----------|------------------------------------|--------|
| mm                                 | inch      |                                | mm   | mm | mm  | mm  | mm | mm    | mm       |                                    |        |
| 6                                  | 1/4       | CF 06                          | 8    | 8  | 8,8 | 22  | 22 | 51,5  | 7,5x17,5 | 0,20                               | 1120   |
| 7-8                                | 9/32-5/16 | CF 08                          | 10   | 9  | 10  | 30  | 24 | 50    | 9x22,5   | 0,27                               | 2000   |
| 10                                 | 3/8       | CF 10                          | 13   | 13 | 14  | 44  | 31 | 72    | 13x31,5  | 0,75                               | 3150   |
| 13                                 | 1/2       | CF 13                          | 17   | 17 | 17  | 53  | 38 | 88    | 16x42    | 1,35                               | 5300   |
| 16                                 | 5/8       | CF 16                          | 20   | 21 | 20  | 64  | 60 | 111   | 21x51,5  | 2,8                                | 8000   |
| 20                                 | 3/4       | CF 20                          | 24   | 24 | 24  | 85  | 65 | 130   | 24x61,5  | 4,8                                | 12500  |
| 22                                 | 7/8       | CF 22                          | 26   | 26 | 26  | 87  | 68 | 139   | 26x72    | 5,65                               | 15000  |
| 26                                 | 1         | CF 26                          | 30,5 | 30 | 35  | 100 | 90 | 190,5 | 30x80    | 13,5                               | 21200  |

**CA**

**GANCIO AD OCCHIO**  
**SLING HOOK WITH LATCH**  
**CROCHET À OEIL AVEC LINGUET**  
**ÖSENLAHAKEN MIT SICHERUNG**

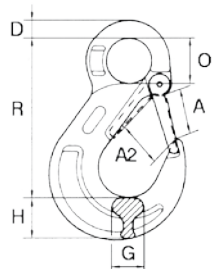

| Catena<br>Chain<br>Chaîne<br>Kette |           | Codice<br>Code<br>Code<br>Code | A    | A2   | D    | G    | H  | O    | R     | Peso<br>Weight<br>Poids<br>Gewicht | W.L.L. |
|------------------------------------|-----------|--------------------------------|------|------|------|------|----|------|-------|------------------------------------|--------|
| mm                                 | inch      |                                | mm   | mm   | mm   | mm   | mm | mm   | mm    |                                    |        |
| 6                                  | 1/4       | CA 06                          | 25   | 20,5 | 8,5  | 14,5 | 20 | 20,5 | 80,5  | 0,27                               | 1120   |
| 7-8                                | 9/32-5/16 | CA 08                          | 29,5 | 24,5 | 11   | 19   | 27 | 25   | 95,5  | 0,50                               | 2000   |
| 10                                 | 3/8       | CA 10                          | 35,7 | 29   | 14   | 23,5 | 33 | 34   | 120,5 | 0,90                               | 3150   |
| 13                                 | 1/2       | CA 13                          | 43,5 | 35,4 | 17,5 | 29   | 40 | 42,5 | 150   | 1,50                               | 5300   |
| 16                                 | 5/8       | CA 16                          | 52,5 | 44   | 22   | 35,5 | 49 | 52   | 183   | 2,75                               | 8000   |
| 20                                 | 3/4       | CA 20                          | 60   | 52   | 27   | 48   | 53 | 55   | 203   | 4,50                               | 12500  |
| 22                                 | 7/8       | CA 22                          | 70   | 62   | 30   | 51,5 | 60 | 60   | 224   | 7,10                               | 15000  |
| 26                                 | 1         | CA 26                          | 77   | 73   | 35   | 60   | 75 | 70   | 237   | 13,8                               | 21200  |
| 32                                 | 1 1/4     | CA 32                          | 95   | 87   | 39   | 71   | 89 | 76   | 259   | 27                                 | 31500  |

Fornibili ganci con sicurezza in lamiera da CA 06 a CA 13  
 These hooks are available also with plate latch from size CA 06 up to CA 13  
 Crochets disponibles aussi avec linguet en tôle de CA 06 à CA 13  
 Haken verfügbar auch mit Sicherung aus Blech von CA 06 bis CA 13

**CRG**

**GANCIO DI SICUREZZA GIREVOLE**  
 SWIVEL SELF LOCKING HOOK  
 CROCHET SECURITÉ A EMERILLON AVEC LINGUET AUTOMATIQUE  
 DREHBARER SICHERHEITSHAKEN MIT AUTOMATISCHER SICHERUNG

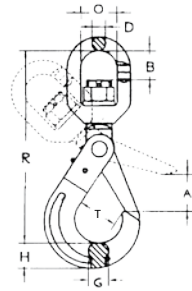

| Catena<br>Chain<br>Chaîne<br>Kette |           | Codice<br>Code<br>Code<br>Code | R   | A  | B  | O  | D  | G  | H  | T  | Peso<br>Weight<br>Poids<br>Gewicht | W.L.L. |
|------------------------------------|-----------|--------------------------------|-----|----|----|----|----|----|----|----|------------------------------------|--------|
| mm                                 | inch      |                                | mm  | mm | mm | mm | mm | mm | mm | mm | Kg                                 | Kg     |
| 6                                  | 1/4       | CRG 06                         | 150 | 28 | 23 | 33 | 11 | 15 | 20 | 35 | 0,6                                | 1120   |
| 7-8                                | 9/32-5/16 | CRG 08                         | 185 | 34 | 27 | 37 | 13 | 19 | 24 | 43 | 1,1                                | 2000   |
| 10                                 | 3/8       | CRG 10                         | 217 | 45 | 35 | 42 | 16 | 23 | 30 | 56 | 2,0                                | 3150   |
| 13                                 | 1/2       | CRG 13                         | 271 | 54 | 43 | 48 | 21 | 27 | 40 | 69 | 4,0                                | 5300   |
| 16                                 | 5/8       | CRG 16                         | 334 | 62 | 58 | 62 | 22 | 37 | 49 | 80 | 6,8                                | 8000   |

**CRO**

**GANCIO DI SICUREZZA AD OCCHIO**  
 SELF LOCKING EYE HOOK  
 CROCHET A VERROUILLAGE AUTOMATIQUE + OEIL  
 SICHERHEITSHAKEN MIT AUTOMATISCHER SICHERUNG

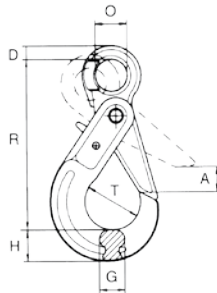

| Catena<br>Chain<br>Chaîne<br>Kette |           | Codice<br>Code<br>Code<br>Code | A  | D  | G  | H  | O  | R   | T   | Peso<br>Weight<br>Poids<br>Gewicht | W.L.L. |
|------------------------------------|-----------|--------------------------------|----|----|----|----|----|-----|-----|------------------------------------|--------|
| mm                                 | inch      |                                | mm | mm | mm | mm | mm | mm  | mm  | Kg                                 | Kg     |
| 6                                  | 1/4       | CRO 06                         | 28 | 11 | 16 | 21 | 21 | 109 | 35  | 0,510                              | 1120   |
| 7-8                                | 9/32-5/16 | CRO 08                         | 34 | 12 | 20 | 26 | 25 | 135 | 43  | 0,936                              | 2000   |
| 10                                 | 3/8       | CRO 10                         | 45 | 16 | 25 | 30 | 33 | 168 | 56  | 1,626                              | 3150   |
| 13                                 | 1/2       | CRO 13                         | 51 | 20 | 35 | 40 | 40 | 205 | 69  | 3,250                              | 5300   |
| 16                                 | 5/8       | CRO 16                         | 60 | 27 | 36 | 50 | 50 | 251 | 80  | 6,050                              | 8000   |
| 20                                 | 3/4       | CRO 20                         | 70 | 30 | 60 | 67 | 60 | 290 | 90  | 10,50                              | 12500  |
| 22                                 | 7/8       | CRO 22                         | 80 | 32 | 62 | 70 | 70 | 322 | 100 | 14,4                               | 15000  |

**CY**

**GANCIO PER FONDERIA**  
 FOUNDRY HOOK  
 CROCHET DE FONDERIE  
 GIESSEREIHAKEN

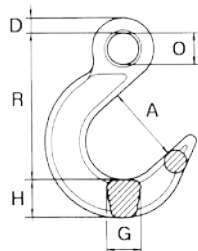

| Catena<br>Chain<br>Chaîne<br>Kette |           | Codice<br>Code<br>Code<br>Code | A    | D    | G  | H  | O  | R     | Peso<br>Weight<br>Poids<br>Gewicht | W.L.L. |
|------------------------------------|-----------|--------------------------------|------|------|----|----|----|-------|------------------------------------|--------|
| mm                                 | inch      |                                | mm   | mm   | mm | mm | mm | mm    | Kg                                 | Kg     |
| 6                                  | 1/4       | CY 06                          | 53,5 | 11,5 | 22 | 26 | 15 | 102,5 | 0,61                               | 1120   |
| 7-8                                | 9/32-5/16 | CY 08                          | 62   | 13,5 | 25 | 29 | 24 | 128   | 0,92                               | 2000   |
| 10                                 | 3/8       | CY 10                          | 76   | 14   | 23 | 30 | 32 | 150   | 1,77                               | 3150   |
| 13                                 | 1/2       | CY 13                          | 89   | 19   | 38 | 40 | 27 | 173   | 2,82                               | 5300   |
| 16                                 | 5/8       | CY 16                          | 102  | 24   | 45 | 48 | 47 | 210   | 5,03                               | 8000   |
| 20                                 | 3/4       | CY 20                          | 114  | 28   | 54 | 60 | 56 | 260   | 7,6                                | 12500  |



**CB**

**GANCIO A FORCELLA**  
**CLEVIS SLING HOOK WITH LATCH**  
**CROCHET À CHAPE AVEC LINGUET**  
**LASTHAKEN MIT GABEL UND SICHERUNG**

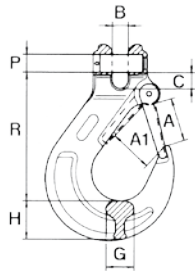

| Catena<br>Chain<br>Chaîne<br>Kette |           | Codice<br>Code<br>Code<br>Code | A    | A1   | B    | C    | G    | H  | P  | R     | Peso<br>Weight<br>Poids<br>Gewicht | W.L.L. |
|------------------------------------|-----------|--------------------------------|------|------|------|------|------|----|----|-------|------------------------------------|--------|
| mm                                 | inch      |                                | mm   | mm   | mm   | mm   | mm   | mm | mm | mm    | Kg                                 | Kg     |
| 6                                  | 1/4       | CB 06                          | 25   | 19   | 6,7  | 8,5  | 14,5 | 20 | 7  | 73    | 0,24                               | 1120   |
| 7-8                                | 9/32-5/16 | CB 08                          | 29,5 | 24,5 | 8,7  | 9,8  | 19   | 27 | 9  | 86,3  | 0,53                               | 2000   |
| 10                                 | 3/8       | CB 10                          | 35,7 | 29   | 12,2 | 13,5 | 23,5 | 33 | 13 | 105   | 0,95                               | 3150   |
| 13                                 | 1/2       | CB 13                          | 43,5 | 35   | 15,3 | 17   | 28,5 | 40 | 16 | 128,5 | 1,67                               | 5300   |
| 16                                 | 5/8       | CB 16                          | 56   | 45   | 18   | 22   | 37   | 48 | 20 | 155   | 3,00                               | 8000   |
| 20                                 | 3/4       | CB 20                          | 61   | 53   | 23   | 26   | 51   | 52 | 24 | 183   | 5,70                               | 12500  |
| 22                                 | 7/8       | CB 22                          | 72   | 62   | 24,5 | 29   | 50   | 62 | 27 | 213   | 8,80                               | 15000  |
| 26                                 | 1         | CB 26                          | 77   | 73   | 30   | 34   | 60   | 75 | 30 | 230   | 13,5                               | 21200  |

Fornibili ganci con sicurezza in lamiera da CB 06 a CB 13  
 These hooks are available also with plate latch from size CB 06 up to CB 13  
 Crochets disponibles aussi avec linguet en tôle de CB 06 à CB 13  
 Haken verfügbar auch mit Sicherung aus Blech von CB 06 bis CB 13

**CRF**

**GANCIO DI SICUREZZA A FORCELLA**  
**SELF LOCKING CLEVIS HOOK**  
**CROCHET SECURITÉ À CHAPE AVEC LINGUET AUTOMATIQUE**  
**SICHERHEITSHAKEN MIT GABEL UND AUTOMATISCHER SICHERUNG**

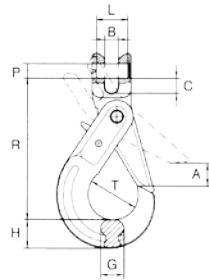

| Catena<br>Chain<br>Chaîne<br>Kette |           | Codice<br>Code<br>Code<br>Code | A  | B  | C  | G  | H  | R   | T   | PxL      | Peso<br>Weight<br>Poids<br>Gewicht | W.L.L. |
|------------------------------------|-----------|--------------------------------|----|----|----|----|----|-----|-----|----------|------------------------------------|--------|
| mm                                 | inch      |                                | mm | mm | mm | mm | mm | mm  | mm  | mm       | Kg                                 | Kg     |
| 6                                  | 1/4       | CRF 06                         | 28 | 7  | 8  | 16 | 21 | 94  | 35  | 7,5x17,5 | 0,496                              | 1120   |
| 7-8                                | 9/32-5/16 | CRF 08                         | 34 | 9  | 10 | 20 | 26 | 123 | 43  | 9x22,5   | 0,934                              | 2000   |
| 10                                 | 3/8       | CRF 10                         | 45 | 12 | 14 | 25 | 30 | 143 | 56  | 13x31,5  | 1,580                              | 3150   |
| 13                                 | 1/2       | CRF 13                         | 51 | 15 | 17 | 35 | 40 | 180 | 69  | 16x42    | 3,200                              | 5300   |
| 16                                 | 5/8       | CRF 16                         | 60 | 19 | 19 | 36 | 50 | 215 | 80  | 21x51,5  | 5,950                              | 8000   |
| 20                                 | 3/4       | CRF 20                         | 70 | 23 | 26 | 60 | 67 | 253 | 90  | 24x73    | 9,800                              | 12500  |
| 22                                 | 7/8       | CRF 22                         | 80 | 26 | 32 | 62 | 70 | 287 | 100 | 26x72    | 14,400                             | 15000  |

**CT**

**GANCIO ANTICOCCIANTE A C**  
**CLEVIS C HOOK**  
**CROCHET C À CHAPE**  
**CLEVIS C HAKEN**

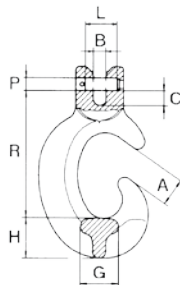

| Catena<br>Chain<br>Chaîne<br>Kette |           | Codice<br>Code<br>Code<br>Code | A  | B  | C  | G  | H  | R   | PxL     | Peso<br>Weight<br>Poids<br>Gewicht | W.L.L. |
|------------------------------------|-----------|--------------------------------|----|----|----|----|----|-----|---------|------------------------------------|--------|
| mm                                 | inch      |                                | mm | mm | mm | mm | mm | mm  | mm      | Kg                                 | Kg     |
| 7-8                                | 9/32-5/16 | CT 08                          | 20 | 9  | 11 | 22 | 27 | 90  | 9x22,5  | 0,56                               | 2000   |
| 10                                 | 3/8       | CT 10                          | 28 | 12 | 14 | 28 | 39 | 129 | 13x31,5 | 1,40                               | 3150   |
| 13                                 | 1/2       | CT 13                          | 39 | 15 | 17 | 35 | 51 | 166 | 16x42   | 3,00                               | 5300   |

**CS**

**GANCIO SCORSOIO**  
**CHOCKER HOOK**  
**CROCHET COULISSANT**  
**SCHLITZRING HAKEN**

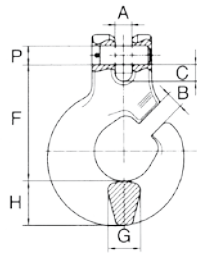







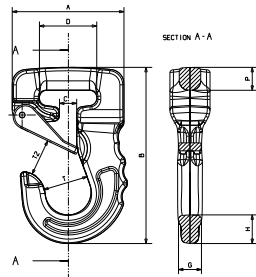

| Catena<br>Chain<br>Chaîne<br>Kette |           | Codice<br>Code<br>Code<br>Code | A    | B    | F  | P  | G  | H   | Peso<br>Weight<br>Poids<br>Gewicht | W.L.L. |
|------------------------------------|-----------|--------------------------------|------|------|----|----|----|-----|------------------------------------|--------|
| mm                                 | inch      |                                | mm   | mm   | mm | mm | mm | mm  | Kg                                 | Kg     |
| 7-8                                | 9/32-5/16 | CS 08                          | 9    | 9,8  | 58 | 9  | 17 | 2,5 | 0,48                               | 2000   |
| 10                                 | 3/8       | CS 10                          | 12,5 | 12,9 | 84 | 13 | 22 | 3,3 | 0,89                               | 3150   |
| 13                                 | 1/2       | CS 13                          | 16,5 | 16   | 94 | 16 | 24 | 4   | 1,50                               | 5300   |

Per uso forestale - non usare per il sollevamento  
 Not to be used for lifting, only for logging  
 Ne pas s'en servir pour le levage, dans le cas d'usage forestier  
 Nicht zum Heben - nur zum Ziehen verwenden

**CJ**

**GANCIO PER FASCIA**  
**JOKER HOOK FOR WEB SLING**  
**CROCHET JOKER POUR ELINGUE**  
**JOKER HAKEN FÜR SCHLINGE**

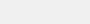

|   | Codice<br>Code<br>Code<br>Code | A   | B   | C  | D   | G  | H  | P  | T    | T2 | Peso<br>Weight<br>Poids<br>Gewicht | W.L.L. |
|---|--------------------------------|-----|-----|----|-----|----|----|----|------|----|------------------------------------|--------|
|   |                                | mm  | mm  | mm | mm  | mm | mm | mm | mm   | mm | Kg                                 | Kg     |
|  | CJ 01                          | 78  | 123 | 12 | 41  | 17 | 20 | 16 | 31   | 26 | 0,7                                | 1000   |
|  | CJ 02                          | 91  | 148 | 19 | 55  | 21 | 26 | 17 | 40   | 31 | 1,2                                | 2000   |
|  | CJ 03                          | 113 | 175 | 21 | 55  | 25 | 32 | 25 | 50   | 37 | 2,2                                | 3000   |
|  | CJ 04                          | 133 | 223 | 40 | 70  | 36 | 40 | 36 | 59,5 | 43 | 4,5                                | 4000   |
|  | CJ 05                          | 133 | 223 | 40 | 70  | 36 | 40 | 36 | 59,5 | 43 | 4,5                                | 5000   |
|  | CJ 06                          | 133 | 223 | 40 | 70  | 36 | 40 | 36 | 59,5 | 43 | 4,5                                | 6000   |
|  | CJ 08                          | 188 | 302 | 50 | 105 | 40 | 60 | 42 | 80   | 65 | 9,7                                | 8000   |
|  | CJ 10                          | 188 | 302 | 50 | 105 | 40 | 60 | 42 | 80   | 65 | 9,7                                | 10000  |

**CYF**

**GANCIO FONDERIA A FORCELLA**  
**FOUNDRIY CLEVIS HOOK**  
**CROCHET DE FONDERIE A CHAPE**  
**GIESSEREIHAKEN MIT GABEL**

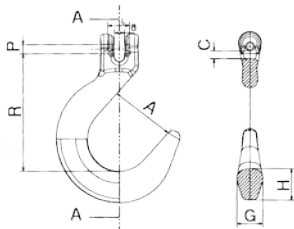

| Catena<br>Chain<br>Chaîne<br>Kette |           | Codice<br>Code<br>Code<br>Code | A    | B   | C    | G  | H    | R     | PxL      | Peso<br>Weight<br>Poids<br>Gewicht | W.L.L. |
|------------------------------------|-----------|--------------------------------|------|-----|------|----|------|-------|----------|------------------------------------|--------|
| mm                                 | inch      |                                | mm   | mm  | mm   | mm | mm   | mm    | mm       | Kg                                 | Kg     |
| 6                                  | 1/4       | CYF 06                         | 53,5 | 8,5 | 6,5  | 22 | 26   | 91    | 7,5x17,5 | 0,7                                | 1120   |
| 7-8                                | 9/32-5/16 | CYF 08                         | 64   | 10  | 11,5 | 26 | 31   | 120,4 | 9x22,5   | 1,1                                | 2000   |
| 10                                 | 3/8       | CYF 10                         | 76   | 13  | 15   | 30 | 34   | 131   | 13x31,5  | 1,7                                | 3150   |
| 13                                 | 1/2       | CYF 13                         | 89   | 17  | 17,5 | 40 | 44,5 | 148   | 16x42    | 3,6                                | 5300   |
| 16                                 | 5/8       | CYF 16                         | 101  | 19  | 21,5 | 45 | 50,5 | 198,5 | 21x51,5  | 5,6                                | 8000   |

**CW**

**GRILLO A FORCELLA**  
**CLEVIS SHACKLE**  
**MANILLE À CHAPE**  
**SCHÄKEL MIT GABEL**

**NEW**

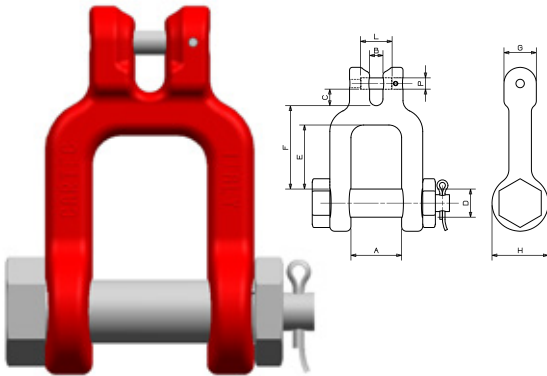

| Catena<br>Chain<br>Chaîne<br>Kette |           | Codice<br>Code<br>Code<br>Code | A  | B  | C    | D  | E    | F    | G  | H  | PxL    | Peso<br>Weight<br>Poids<br>Gewicht | W.L.L. |
|------------------------------------|-----------|--------------------------------|----|----|------|----|------|------|----|----|--------|------------------------------------|--------|
| mm                                 | inch      |                                | mm | mm | mm   | mm | mm   | mm   | mm | mm | mm     | Kg                                 | Kg     |
| 6                                  | 1/4       | CW 06                          | 36 | 9  | 11,5 | 20 | 45,5 | 59,5 | 23 | 40 | 8x22,5 | 0,8                                | 1120   |
| 7-8                                | 9/32-5/16 | CW 08                          | 36 | 9  | 11   | 20 | 45,5 | 59,5 | 23 | 40 | 9x22,5 | 0,8                                | 2000   |

**CKS  
CKL**

**KIT DI SICUREZZA PER GANCI**  
**LATCH KIT FOR HOOKS**  
**KIT SECURITÉ POUR CROCHETS**  
**SICHERHEITS-ERSATZTEILE FÜR ÖSENLASTHAKEN**

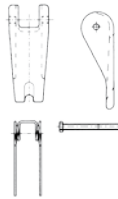

| Catena<br>Chain<br>Chaîne<br>Kette |           | Codice aletta forgiata<br>Code of forged latch<br>Code de la linguet forgé<br>Code für geschmiedete Sicherung | Codice aletta in lamiera<br>Code of plate latch<br>Code de la linguet en tôle<br>Code für Blech-Sicherung | Accessorio d'utilizzo<br>Accessory of use<br>Accessoire d'utilisation<br>Verwendungs-Zubehörteil |
|------------------------------------|-----------|---|---|--|
| mm                                 | inch      |   |   |  |
| 6                                  | 1/4       | CKS 06  | CKL 06  | CA 06-CB 06  |
| 7-8                                | 9/32-5/16 | CKS 08  | CKL 08  | CA 08-CB 08-CJ 01  |
| 10                                 | 3/8       | CKS 10  | CKL 10  | CA 10-CB 10-CJ 02-CJ 03  |
| 13                                 | 1/2       | CKS 13  | CKL 13  | CA 13-CB 13-CJ 04-CJ 05-CJ 06  |
| 16                                 | 5/8       | CKS 16  |   | CA 16  |
| 16                                 | 5/8       | CKS 16B   |   | CB 16  |
| 20                                 | 3/4       | CKS 20B   |   | CA 20-CB 20  |
| 22                                 | 7/8       | CKS 22  |   | CA 22-CB 22-CJ 08-CJ 10  |
| 26                                 | 1         | CKS 26  |   | CA 26-CB 26  |
| 32                                 | 1 1/4     | CKS 32  |   | CA 32  |

**CKSL**

**KIT DI SICUREZZA PER GANCI SELF LOCKING**  
**LOCKING SYSTEM KIT FOR SELF LOCKING HOOKS**  
**KIT SECURITÉ POUR CROCHETS SELF LOCKING**  
**SICHERHEITS-VERSCHLUSS FÜR SICHERHEITSHAKEN**

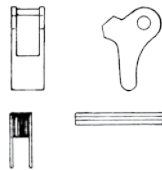

| Catena<br>Chain<br>Chaîne<br>Kette |           | Codice<br>Code<br>Code<br>Code | Accessorio d'utilizzo<br>Accessory of use<br>Accessoire d'utilisation<br>Verwendungs-Zubehörteil |
|------------------------------------|-----------|--------------------------------|--|
| mm                                 | inch      |                                |  |
| 6                                  | 1/4       | CKSL 06                        | CRF 06-CRO 06-CRG 06   |
| 7-8                                | 9/32-5/16 | CKSL 08                        | CRF 08-CRO 08-CRG 08   |
| 10                                 | 3/8       | CKSL 10                        | CRF 10-CRO 10-CRG 10   |
| 13                                 | 1/2       | CKSL 13                        | CRF 13-CRO 13-CRG 13   |
| 16                                 | 5/8       | CKSL 16                        | CRF 16-CRO 16-CRG 16   |
| 20                                 | 3/4       | CKSL 20                        | CRF 20-CRO 20  |
| 22                                 | 7/8       | CKSL 22                        | CRF 22-CRO 22  |

**CKP**

**SET PERNO PER GANCI A FORCELLA**  
**KIT OF PIN FOR CLEVIS HOOKS**  
**SET DE GOUJON POUR CROCHETS À CHAPE**  
**BOLZEN-GARNITUR FÜR GABELHAKEN**



| Catena<br>Chain<br>Chaîne<br>Kette |           | Codice<br>Code<br>Code<br>Code | Accessorio d'utilizzo<br>Accessory of use<br>Accessoire d'utilisation<br>Verwendungs-Zubehörteil        |
|------------------------------------|-----------|--------------------------------|---|
| mm                                 | inch      |                                |   |
| 6                                  | 1/4       | CKP 06                         | CB 06-CRF 06-CX 06-CX 06S<br>CX 07S-CX 07   |
| 7                                  | 9/32      | CKP 07S                        | CYF 08-CB 08-CF 08-CRF 08-CS 08-CT 08<br>CX 08S-CX 08   |
| 7-8                                | 9/32-5/16 | CKP 08                         | CB 10-CF 10-CRF 10-CS 10-CT 10-CX 10-CX 10S<br>CYF 10   |
| 8                                  | 5/16      | CKP 08S                        | CB 13-CF 13-CRF 13-CS 13-CT 13-CX 13-CX 13S<br>CYF 13   |
| 10                                 | 3/8       | CKP 10                         | CF 16-CRF 16-CX 16-CX 16S<br>CB 16-CYF 16<br>CF 20<br>CB 20-CRF 20<br>CB 22-CF 22-CRF 22<br>CB 26-CF 26 |
| 10                                 | 3/8       | CKP 10F                        |   |
| 13                                 | 1/2       | CKP 13                         |   |
| 13                                 | 1/2       | CKP 13F                        |   |
| 16                                 | 5/8       | CKP 16                         |   |
| 16                                 | 5/8       | CKP 16B                        |   |
| 20                                 | 3/4       | CKP 20                         |   |
| 20                                 | 3/4       | CKP 20B                        |   |
| 22                                 | 7/8       | CKP 22                         |   |
| 26                                 | 1         | CKP 26                         |   |

**CKX**

**KIT SICURA ACCORCIATORI**  
**LOCKING SYSTEM KIT FOR SHORTENING CLUTCH**  
**KIT SÉCURITÉ POUR GRIFFE DE RACCOURCISSEMENT**  
**SICHERHEITS-VERSCHLUSS FÜR VERKÜRZUNGKLAUE**

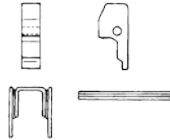

| Catena<br>Chain<br>Chaîne<br>Kette |      | Codice<br>Code<br>Code<br>Code | Accessorio d'utilizzo<br>Accessory of use<br>Accessoire d'utilisation<br>Verwendungs-Zubehörteil |
|------------------------------------|------|--------------------------------|--|
| mm                                 | inch |                                |  |
| 6                                  | 1/4  | CKX 06                         | CX 06S   |
| 7                                  | 9/32 | CKX 07                         | CX 07S   |
| 8                                  | 5/16 | CKX 08                         | CX 08S   |
| 10                                 | 3/8  | CKX 10                         | CX 10S   |
| 13                                 | 1/2  | CKX 13                         | CX 13S   |
| 16                                 | 5/8  | CKX 16                         | CX 16S   |

**CLK**

**KIT PERNO + MOLLA MAGLIA**  
**KIT PIN + COMPASS CONN.LINK**  
**KIT AXE + RESSORT**  
**BOLZEN-GARNITUR + FEDER FÜR VERBINDUNGSGLIED**

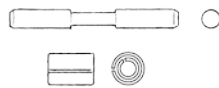

| Catena<br>Chain<br>Chaîne<br>Kette |       | Codice<br>Code<br>Code<br>Code | Accessorio d'utilizzo<br>Accessory of use<br>Accessoire d'utilisation<br>Verwendungs-Zubehörteil |
|------------------------------------|-------|--------------------------------|--|
| mm                                 | inch  |                                |  |
| 6                                  | 1/4   | CLK 06                         | CL 06  |
| 7                                  | 9/32  | CLK 07                         | CL 07  |
| 8                                  | 5/16  | CLK 08                         | CL 08  |
| 10                                 | 3/8   | CLK 10                         | CL 10  |
| 13                                 | 1/2   | CLK 13                         | CL 13  |
| 16                                 | 5/8   | CLK 16                         | CL 16  |
| 20                                 | 3/4   | CLK 20                         | CL 20  |
| 22                                 | 7/8   | CLK 22                         | CL 22  |
| 26                                 | 1     | CLK 26                         | CL 26  |
| 32                                 | 1 1/4 | CLK 32                         | CL 32  |

I kit di ricambio devono essere assemblati solo su accessori di sollevamento "CARTEC" marcati .  
 Replacement kits must be assembled only on "CARTEC" accessories for lifting marked .  
 Les sets de rechange doivent être assemblés seulement sur accessoires de levage "CARTEC" marqués .  
 Die ersatzteile koennen nur zu artikel der marke "CARTEC" verwendet werden .

**TI**

**TARGHETTA DI IDENTIFICAZIONE**  
**IDENTIFICATION TAG**  
**PLAQUE DE IDENTIFICATION**  
**KENNZEICHNUNG STAHLN-HÄNGER**

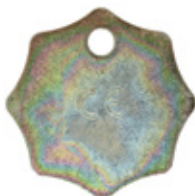

| Targhetta<br>Tag<br>Plaque<br>Stahln-Hänger |  | Anello per targhetta<br>Only ring<br>Anneau<br>Ring |
|---|--|---|
| 1 braccio<br>1 leg<br>1 brin<br>1 Strang    | 2/3/4 bracci<br>2/3/4 legs<br>2/3/4 brins<br>2/3/4 Stränge |   |
| TI 01                                       | TI 02  | AT 00   |



f= freccia di flessione  
 F= bend deflection  
 F= flèche de pliage  
 F= Durchbiegung

Coefficiente di sicurezza 4:1  
 Safety factor 4:1  
 Coefficient de sécurité 4:1  
 Belastungsgrad 4:1

| Catena<br>Chain<br>Chaîne<br>Kette | Codice<br>Code<br>Code<br>Code | Tolleranza<br>Tolerance<br>Tolérances<br>Zul. Abw. | P      | Tolleranza<br>Tolerance<br>Tolérances<br>Zul. Abw. | Li<br>min | Le<br>max | Peso<br>Weight<br>Poids<br>Gewicht | W.L.L. | M.P.F. | B.F. | f<br>mm |     |
|------------------------------------|--------------------------------|--|--------|--|-----------|-----------|------------------------------------|--------|--------|------|---------|-----|
| Ø mm                               | inch                           | mm   | mm     | mm   | mm        | mm        | Kg/m                               | Kg     | KN     | KN   | mm      |     |
| 6                                  | 1/4                            | C818206  | ± 0,24 | 18   | ± 0,5     | 7,8       | 22,2                               | 0,8    | 1120   | 28,3 | 45,2    | 4,8 |
| 7                                  | 9/32                           | C818207  | ± 0,28 | 21   | ± 0,6     | 9,1       | 25,9                               | 1,1    | 1500   | 38,5 | 61,6    | 5,6 |
| 8                                  | 5/16                           | C818208  | ± 0,32 | 24   | ± 0,7     | 10,4      | 29,6                               | 1,4    | 2000   | 50,3 | 80,4    | 6,4 |
| 10                                 | 3/8                            | C818210  | ± 0,40 | 30   | ± 0,9     | 13        | 37                                 | 2,2    | 3150   | 78,5 | 126     | 8   |
| 13                                 | 1/2                            | C818213  | ± 0,52 | 39   | ± 1,2     | 16,9      | 48,1                               | 3,8    | 5300   | 133  | 212     | 10  |
| 16                                 | 5/8                            | C818216  | ± 0,64 | 48   | ± 1,4     | 20,8      | 59,2                               | 5,7    | 8000   | 201  | 322     | 13  |
| 20                                 | 3/4                            | C818220  | ± 1,00 | 60   | ± 1,8     | 26        | 74                                 | 9      | 12500  | 314  | 503     | 16  |
| 22                                 | 7/8                            | C818222  | ± 1,10 | 66   | ± 2,0     | 28,6      | 81,4                               | 10,9   | 15000  | 380  | 608     | 18  |
| 26                                 | 1                              | C818226  | ± 1,30 | 78   | ± 2,3     | 33,8      | 96,2                               | 15,2   | 21200  | 531  | 849     | 21  |
| 32                                 | 1 1/4                          | C818232  | ± 1,60 | 96   | ± 2,9     | 41,6      | 118                                | 23     | 31500  | 804  | 1290    | 26  |

**CARICHI MASSIMI DI UTILIZZO DELLE IMBRAGHE**  
 WORKING LOAD LIMITS OF SLINGS  
 CHARGE MAXIMALE D'UTILISATION POUR ELINGUE  
 HÖCHSTE TRAGFÄHIGKEIT FÜR ANSCHLAGKETTEN

**Portate secondo norma EN 818-4**  
 W.L.L. according to EN 818-4  
 W.L.L. selon EN 818-4  
 Tragfähigkeit gemäß der Norm EN 818-4

| Catena<br>Chain<br>Chaîne<br>Kette  | A braccio singolo<br>Single leg<br>1 brin<br>1 Strang | A2 bracci<br>2 legs<br>2 brins<br>2 Stränge | A3 e 4 bracci<br>3-4 legs<br>3-4 brins<br>3-4 Stränge | Brache senza fine a scorsoio<br>Choker endless slings<br>Elingue sans fin a coulissant<br>Endlose Schlingketten | Brache a cesto<br>Legged slings<br>Chaîne à bouche<br>Schlaufengehänge |       |                     |                     |
|---|---|---|---|---|--|-------|---------------------|---------------------|
|   |   |   |   |   |  |       |                     |                     |
| Fattore di carico<br>Charge factor<br>Facteur de charge<br>Traglastfaktor | 1   | 1,4<br>0° < β ≤ 45°                         | 1<br>45° < β ≤ 60°                                    | 2,1<br>0° < β ≤ 45°   | 1,5<br>45° < β ≤ 60°   | 1,6   | 1,4<br>0° < β ≤ 45° | 2,1<br>0° < β ≤ 45° |
| mm  | Kg  | Kg  | Kg  | Kg  | Kg   | Kg    | Kg                  | Kg                  |
| 6   | 1120  | 1600  | 1120  | 2360  | 1700   | 1800  | 1600                | 2360                |
| 7   | 1500  | 2120  | 1500  | 3150  | 2240   | 2500  | 2120                | 3150                |
| 8   | 2000  | 2800  | 2000  | 4250  | 3000   | 3150  | 2800                | 4250                |
| 10  | 3150  | 4250  | 3150  | 6700  | 4750   | 5000  | 4250                | 6700                |
| 13  | 5300  | 7500  | 5300  | 11200   | 8000   | 8500  | 7500                | 11200               |
| 16  | 8000  | 11200                                       | 8000  | 17000   | 11800  | 12500 | 11200               | 17000               |
| 20  | 12500   | 17000                                       | 12500   | 26500   | 19000  | 20000 | 17000               | 26500               |
| 22  | 15000   | 21200                                       | 15000   | 31500   | 22400  | 23600 | 21200               | 31500               |
| 26  | 21200   | 30000                                       | 21200   | 45000   | 31500  | 33500 | 30000               | 45000               |
| 32  | 31500   | 45000                                       | 31500   | 67000   | 47500  | 50000 | 45000               | 67000               |

**IMPIEGO DELLA CATENA SU SPIGOLO**  
 USE OF THE CHAIN ON EDGE  
 USAGE DE LA CHAÎNE SUT LE COIN  
 KANTENBELASTUNG

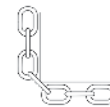
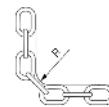
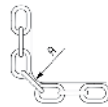

|   | R ≥ a due volte il diametro della catena<br>R ≥ than double chain-diameter<br>R ≥ à deux fois le diamètre de la chaîne<br>R ≥ als 2x Ketten-Durchmesser | R ≥ al diametro della catena<br>R ≥ than the chain-diameter<br>R ≥ le diamètre de la chaîne<br>R ≥ als Ketten-Durchmesser | Spigolo vivo<br>Sharp edge<br>Coin vie<br>Scharfe Kanten             |
|---|---|---|--|
| Fattore di riduzione<br>Reduction factor<br>Facteur de réduction<br>Reduktionsfaktor    | 1   | 0,7   | 0,5  |
| Carico impulsivo<br>impulsive load<br>Chargé impulsive<br>Stoßbelastung (O-Norm M 9605) | Leggera pulsazione<br>Light impulse<br>Léger pulsation<br>Leichte Stöße   | Media pulsazione<br>Medium impulse<br>Moyenne pulsation<br>Mittlere Stöße   | Forte pulsazione<br>Strong impulse<br>Fort pulsation<br>Starke Stöße |
| Fattore di riduzione<br>Reduction factor<br>Facteur de réduction<br>Reduktionsfaktor    | 1   | 0,7   | Non consentito<br>Not allowed<br>Pas consentit<br>Unzulässig         |



## CM CMS

### ANELLO OVALE OBLONG MASTERLINK MAILLE DE TÊTE OVALE OVAL AUFHÄNGERINGE

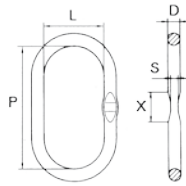

Portate secondo norma EN 818-4  
W.L.L. according to EN 818-4  
W.L.L. selon standard EN 818-4  
Tragfähigkeit gemäß der Norm EN 818-4

| Catena<br>Chain<br>Chaîne<br>Kette |           | Codice<br>Code<br>Code<br>Code | (con schiacciatura)<br>(with flat)<br>(avec entree plate)<br>(mit Flachstelle) | Dimensioni secondo DIN 5688-86<br>Size according to DIN 5688-86<br>Dimension selon DIN 5688-86<br>Maß-Tabelle nach DIN 5688-86 |         |         |           | Peso<br>Weight<br>Poids<br>Gewicht | W.L.L. |  |
|------------------------------------|-----------|--------------------------------|--|--|---------|---------|-----------|------------------------------------|--------|--|
| ⊥<br>∅ mm                          | ∧<br>∅ mm |                                |  | D<br>mm  | P<br>mm | L<br>mm | SxX<br>mm | Kg                                 | Kg     |  |
| 7                                  | 6         | CM 0706                        | CMS 0706   | 13   | 110     | 60      | 8x25      | 0,34                               | 1600   |  |
| 8                                  | 7         | CM 0807                        | CMS 0807   | 16   | 110     | 60      | 8x25      | 0,53                               | 2120   |  |
| 10                                 | 8         | CM 1008                        | CMS 1008   | 18   | 135     | 75      | 8x35      | 0,915                              | 3150   |  |
| 13                                 | 10        | CM 1310                        | CMS 1310   | 22   | 160     | 90      | 11,5x35   | 1,60                               | 5300   |  |
| 16                                 | 13        | CM 1613                        | CMS 1613   | 26   | 180     | 100     | 14x46     | 2,46                               | 8000   |  |
| 18                                 | 16        | CM 1816                        | CMS 1816   | 32   | 200     | 110     | 18x46     | 4,14                               | 11200  |  |
| 20                                 | 18        | CM 2018                        |  | 36   | 260     | 140     |           | 6,22                               | 14000  |  |
| 22                                 | 20        | CM 2220                        |  | 40   | 300     | 160     |           | 8,95                               | 17000  |  |
| 26                                 | 22        | CM 2622                        |  | 45   | 340     | 180     |           | 12,82                              | 21200  |  |
| 32                                 | 26        | CM 3226                        |  | 51   | 350     | 190     |           | 16,51                              | 31500  |  |
| 36                                 | 32        | CM 3632                        |  | 57   | 400     | 200     |           | 27,01                              | 45000  |  |
| 40                                 | 36        | CM 4036                        |  | 57   | 400     | 200     |           | 27,01                              | 56000  |  |

## CMC CMCS

### ANELLI COMPLESSI SUB-ASSEMBLY MAILLON DE TÊTE TRIPLE AUFHÄNGEKÖPFE

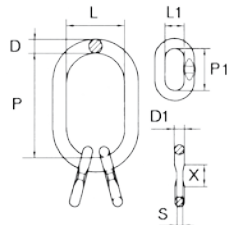

| Catena<br>Chain<br>Chaîne<br>Kette |  | Codice<br>Code<br>Code<br>Code | (con schiacciatura)<br>(with flat)<br>(avec entree plate)<br>(mit Flachstelle) | Dimensioni secondo DIN 5688-86<br>Size according to DIN 5688-86<br>Dimension selon DIN 5688-86<br>Maß-Tabelle nach DIN 5688-86 |         |         |          | Peso<br>Weight<br>Poids<br>Gewicht | W.L.L.   |           |       |       |
|------------------------------------|--|--------------------------------|--|--|---------|---------|----------|------------------------------------|----------|-----------|-------|-------|
| ∧<br>∅ mm                          |  |                                |  | D<br>mm  | P<br>mm | L<br>mm | D1<br>mm | P1<br>mm                           | L1<br>mm | SxX<br>mm | Kg    | Kg    |
| 6                                  |  | CMC 06                         | CMCS 06  | 18   | 135     | 75      | 13       | 54                                 | 25       | 8x25      | 1,315 | 2360  |
| 7                                  |  | CMC 07                         | CMCS 07  | 18   | 135     | 75      | 13       | 54                                 | 25       | 8x25      | 1,315 | 3150  |
| 8                                  |  | CMC 08                         | CMCS 08  | 22   | 160     | 90      | 16       | 70                                 | 34       | 8x25      | 2,32  | 4250  |
| 10                                 |  | CMC 10                         | CMCS 10  | 26   | 180     | 100     | 18       | 85                                 | 40       | 11,5x35   | 3,52  | 6700  |
| 13                                 |  | CMC 13                         | CMCS 13  | 32   | 200     | 110     | 22       | 115                                | 50       | 14x35     | 6,26  | 11200 |
| 16                                 |  | CMC 16                         | CMCS 16  | 36   | 260     | 140     | 26       | 140                                | 65       | 18x46     | 9,56  | 17000 |
| 18                                 |  | CMC 18                         |  | 45   | 340     | 180     | 32       | 150                                | 70       |           | 18,92 | 21200 |
| 20                                 |  | CMC 20                         |  | 51   | 350     | 190     | 32       | 150                                | 70       |           | 22,65 | 26500 |
| 22                                 |  | CMC 22                         |  | 51   | 350     | 190     | 36       | 170                                | 75       |           | 25,19 | 31500 |
| 26                                 |  | CMC 26                         |  | 57   | 400     | 200     | 40       | 170                                | 80       |           | 36,01 | 45000 |
| 32                                 |  | CMC 32                         |  | 70   | 460     | 250     | 50       | 200                                | 100      |           | 64,40 | 67000 |

## CN CNS

### ANELLO OVALE SPECIALE SPECIAL OBLONG MASTERLINK MAILLE DE TÊTE OVALE SPÉCIALE SONDER-OVAL AUFHÄNGERINGE

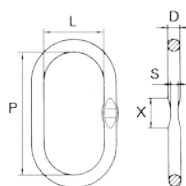

| Catena<br>Chain<br>Chaîne<br>Kette |           | Codice<br>Code<br>Code<br>Code | (con schiacciatura)<br>(with flat)<br>(avec entree plate)<br>(mit Flachstelle) | Dimensioni secondo DIN 5688-86<br>Size according to DIN 5688-86<br>Dimension selon DIN 5688-86<br>Maß-Tabelle nach DIN 5688-86 |         |         |           | Peso<br>Weight<br>Poids<br>Gewicht | W.L.L. |  |
|------------------------------------|-----------|--------------------------------|--|--|---------|---------|-----------|------------------------------------|--------|--|
| ⊥<br>∅ mm                          | ∧<br>∅ mm |                                |  | D<br>mm  | P<br>mm | L<br>mm | SxX<br>mm | Kg                                 | Kg     |  |
| 8                                  | 7         | CN 0807                        | CNS 0807   | 14   | 120     | 70      | 8x25      | 0,44                               | 2700   |  |
| 10                                 | 8         | CN 1008                        | CNS 1008   | 16   | 140     | 80      | 8x25      | 0,67                               | 3500   |  |
| 13                                 | 10        | CN 1310                        | CNS 1310   | 20   | 160     | 95      | 11,5x35   | 1,20                               | 5500   |  |
| 16                                 | 13        | CN 1613                        | CNS 1613   | 27   | 190     | 110     | 14x45     | 2,65                               | 9400   |  |
| 20                                 | 16        | CN 2016                        | CNS 2016   | 33   | 230     | 130     | 18x45     | 4,80                               | 14200  |  |
| 22                                 | 20        | CN 2220                        |  | 38   | 275     | 150     |           | 7,50                               | 22300  |  |
| 26                                 | 22        | CN 2622                        |  | 45   | 340     | 180     |           | 12,80                              | 33500  |  |
| 32                                 | 26        | CN 3226                        |  | 50   | 350     | 190     |           | 16,50                              | 40800  |  |
| 36                                 | 32        | CN 3632                        |  | 60   | 400     | 200     |           | 27,00                              | 56800  |  |

## CNC CNCS

### ANELLI COMPLESSI SPECIALI SPECIAL SUB-ASSEMBLY MAILLONS DE TÊTE TRIPLE SPÉCIAUX SONDERAUFHÄNGEKÖPFE

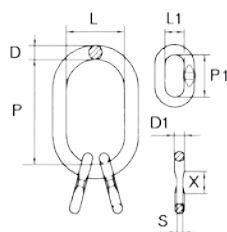

| Catena<br>Chain<br>Chaîne<br>Kette |  | Codice<br>Code<br>Code<br>Code | (con schiacciatura)<br>(with flat)<br>(avec entree plate)<br>(mit Flachstelle) | Dimensioni secondo DIN 5688-86<br>Size according to DIN 5688-86<br>Dimension selon DIN 5688-86<br>Maß-Tabelle nach DIN 5688-86 |         |         |          | Peso<br>Weight<br>Poids<br>Gewicht | W.L.L.   |           |       |       |
|------------------------------------|--|--------------------------------|--|--|---------|---------|----------|------------------------------------|----------|-----------|-------|-------|
| ∧<br>∅ mm                          |  |                                |  | D<br>mm  | P<br>mm | L<br>mm | D1<br>mm | P1<br>mm                           | L1<br>mm | SxX<br>mm | Kg    | Kg    |
| 7                                  |  | CNC 07                         | CNCS 07  | 20   | 160     | 95      | 14       | 120                                | 70       | 8x25      | 2,90  | 5500  |
| 8                                  |  | CNC 08                         | CNCS 08  | 23   | 160     | 110     | 16       | 140                                | 80       | 8x25      | 3,10  | 6700  |
| 10                                 |  | CNC 10                         | CNCS 10  | 27   | 190     | 110     | 20       | 160                                | 95       | 11,5x35   | 5,00  | 9400  |
| 13                                 |  | CNC 13                         | CNCS 13  | 33   | 230     | 130     | 27       | 190                                | 110      | 14x45     | 10,00 | 14200 |
| 16                                 |  | CNC 16                         | CNCS 16  | 38   | 275     | 150     | 33       | 230                                | 130      | 18x45     | 17,00 | 22300 |
| 20                                 |  | CNC 20                         |  | 45   | 340     | 180     | 38       | 275                                | 150      |           | 27,80 | 33500 |
| 22                                 |  | CNC 22                         |  | 50   | 350     | 190     | 45       | 340                                | 180      |           | 42,20 | 40800 |
| 26                                 |  | CNC 26                         |  | 60   | 400     | 200     | 50       | 350                                | 190      |           | 60,10 | 56800 |

Meet or exceed ASTM A952/A906 specifications.

## CP1

**ANELLONI CON ATTACCO A FORCELLA**  
**MASTER LINKS WITH CLEVIS ATTACHMENTS**  
**MAILLON DE TÊTE AVEC ATTACHE À CHAPE**  
**AUFHÄNGEKÖPFE MIT GABELVERBINDER**

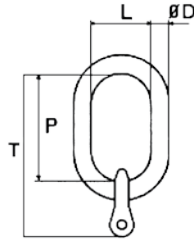

| Catena<br>Chain<br>Chaîne<br>Kette | Codice<br>Code<br>Code<br>Code | Dimensioni secondo DIN 5688-86<br>Size according to DIN 5688-86<br>Dimension selon DIN 5688-86<br>Maß-Tabelle nach DIN 5688-86 |     |     |     | Peso<br>Weight<br>Poids<br>Gewicht | W.L.L. |    |
|------------------------------------|--------------------------------|--|-----|-----|-----|------------------------------------|--------|----|
|                                    |                                | Ø D  | P   | L   | T   |                                    | Kg     | Kg |
| ⊥                                  |                                | mm   | mm  | mm  | mm  | Kg                                 | Kg     |    |
| Ø mm                               |                                | mm   | mm  | mm  | mm  | Kg                                 | Kg     |    |
| 6                                  | CP106                          | 13   | 110 | 60  | 140 | 0,58                               | 1,120  |    |
| 8                                  | CP108                          | 16   | 110 | 60  | 151 | 0,88                               | 2,000  |    |
| 10                                 | CP110                          | 18   | 135 | 75  | 185 | 1,35                               | 3,150  |    |
| 13                                 | CP113                          | 22   | 160 | 90  | 223 | 2,40                               | 5,300  |    |
| 16                                 | CP116                          | 26   | 180 | 100 | 257 | 4,00                               | 8,000  |    |

Portate secondo norma EN/DIN 5688-3  
 W.L.L. according to EN 818-4/DIN 5688-3  
 W.L.L. selon standard EN 818-4/DIN 5688-3  
 Tragfähigkeit gemäß der Norm EN 818-4/DIN 5688-3

## CP2

**ANELLONI CON ATTACCO A FORCELLA**  
**MASTER LINKS WITH CLEVIS ATTACHMENTS**  
**MAILLON DE TÊTE AVEC ATTACHE À CHAPE**  
**AUFHÄNGEKÖPFE MIT GABELVERBINDER**

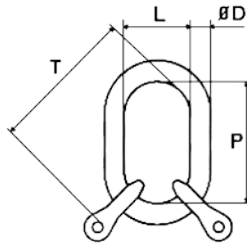

| Catena<br>Chain<br>Chaîne<br>Kette | Codice<br>Code<br>Code<br>Code | Dimensioni secondo DIN 5688-86<br>Size according to DIN 5688-86<br>Dimension selon DIN 5688-86<br>Maß-Tabelle nach DIN 5688-86 |     |     |     | Peso<br>Weight<br>Poids<br>Gewicht | W.L.L.  |          |
|------------------------------------|--------------------------------|--|-----|-----|-----|------------------------------------|---------|----------|
|                                    |                                | Ø D  | P   | L   | T   |                                    | 0°- 45° | 45°- 60° |
| ∧                                  |                                | mm   | mm  | mm  | mm  | Kg                                 | Kg      | Kg       |
| Ø mm                               |                                | mm   | mm  | mm  | mm  | Kg                                 | Kg      | Kg       |
| 6                                  | CP206                          | 13   | 110 | 60  | 140 | 0,70                               | 1,600   | 1,120    |
| 8                                  | CP208                          | 18   | 135 | 75  | 176 | 1,40                               | 2,800   | 2,000    |
| 10                                 | CP210                          | 22   | 160 | 90  | 210 | 2,45                               | 4,250   | 3,150    |
| 13                                 | CP213                          | 26   | 180 | 100 | 243 | 4,20                               | 7,500   | 5,300    |
| 16                                 | CP216                          | 32   | 200 | 110 | 277 | 7,05                               | 11,200  | 8,000    |

Portate secondo norma EN 818-4/DIN 5688-3  
 W.L.L. according to EN 818-4/DIN 5688-3  
 W.L.L. selon standard EN 818-4/DIN 5688-3  
 Tragfähigkeit gemäß der Norm EN 818-4/DIN 5688-3

## CP4

**ANELLONI CON ATTACCO A FORCELLA**  
**MASTER LINKS WITH CLEVIS ATTACHMENTS**  
**MAILLON DE TÊTE AVEC ATTACHE À CHAPE**  
**AUFHÄNGEKÖPFE MIT GABELVERBINDER**

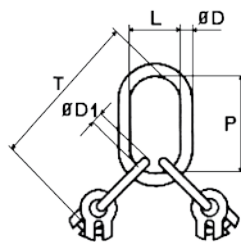

| Catena<br>Chain<br>Chaîne<br>Kette | Codice<br>Code<br>Code<br>Code | Dimensioni secondo DIN 5688-86<br>Size according to DIN 5688-86<br>Dimension selon DIN 5688-86<br>Maß-Tabelle nach DIN 5688-86 |     |     |      |     | Peso<br>Weight<br>Poids<br>Gewicht | W.L.L.  |          |
|------------------------------------|--------------------------------|--|-----|-----|------|-----|------------------------------------|---------|----------|
|                                    |                                | Ø D  | P   | L   | Ø D1 | T   |                                    | 0°- 45° | 45°- 60° |
| ∧                                  |                                | mm   | mm  | mm  | mm   | mm  | Kg                                 | Kg      | Kg       |
| Ø mm                               |                                | mm   | mm  | mm  | mm   | mm  | Kg                                 | Kg      | Kg       |
| 6                                  | CP406                          | 18   | 135 | 75  | 13   | 219 | 1,65                               | 2,360   | 1,700    |
| 8                                  | CP408                          | 22   | 160 | 90  | 16   | 271 | 3,20                               | 4,250   | 3,000    |
| 10                                 | CP410                          | 26   | 180 | 100 | 18   | 315 | 5,30                               | 6,700   | 4,750    |
| 13                                 | CP413                          | 32   | 200 | 110 | 22   | 378 | 9,40                               | 11,200  | 8,000    |
| 16                                 | CP416                          | 36   | 260 | 140 | 26   | 477 | 16,30                              | 17,000  | 11,800   |

Portate secondo norma EN 818-4/DIN 5688-3  
 W.L.L. according to EN 818-4/DIN 5688-3  
 W.L.L. selon standard EN 818-4/DIN 5688-3  
 Tragfähigkeit gemäß der Norm EN 818-4/DIN 5688-3

CO

**ANELLONI SPECIALI PER GANCI DIN 15401**  
**SPECIAL MASTER LINKS FOR CRANE HOOKS DIN 15401**  
**MAILLON DE TÊTE SPÉCIAUX POUR CROCHET DIN 15401**  
**AUFHÄNGEGLIEDER/AUFHÄNGEKÖPFE FÜR EIFACHKRANHKEN DIN 15401**

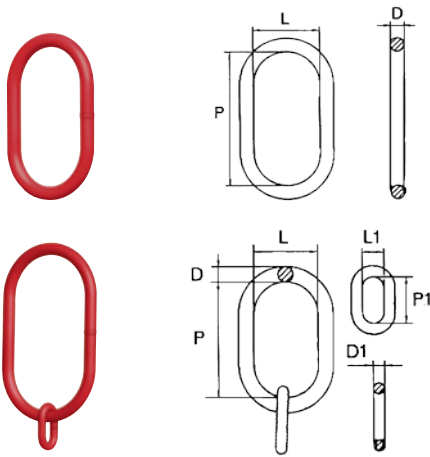

| Catena<br>Chain<br>Chaîne<br>Kette | Codice<br>Code<br>Code<br>Code | Dimensioni secondo DIN 5688-86<br>Size according to DIN 5688-86<br>Dimension selon DIN 5688-86<br>Maß-Tabelle nach DIN 5688-86 |    |     |     |     |    | Peso<br>Weight<br>Poids<br>Gewicht | W.L.L.<br>Kg |
|------------------------------------|--------------------------------|--|----|-----|-----|-----|----|------------------------------------|--------------|
|                                    |                                | D  | D1 | P   | P1  | L   | L1 |                                    |              |
| ∅ mm                               |                                | mm   | mm | mm  | mm  | mm  | mm | Kg                                 | Kg           |
| 6                                  | CO8T106                        | 13   | -  | 180 | -   | 100 | -  | 0,60                               | 1120         |
| 8                                  | COC8T108                       | 18   | -  | 180 | -   | 100 | -  | 1,06                               | 2000         |
| 10                                 | CO8T110                        | 20   | -  | 180 | -   | 100 | -  | 1,32                               | 3150         |
| 13                                 | CO8T113                        | 22   | -  | 180 | -   | 100 | -  | 1,62                               | 5300         |
| 6                                  | COC16T106                      | 20   | 13 | 260 | 54  | 140 | 25 | 2,02                               | 1120         |
| 8                                  | COC16T108                      | 20   | 16 | 260 | 70  | 140 | 34 | 2,20                               | 2000         |
| 10                                 | CO16T110                       | 22   | -  | 260 | -   | 140 | -  | 2,21                               | 3150         |
| 13                                 | CO16T113                       | 26   | -  | 260 | -   | 140 | -  | 3,18                               | 5300         |
| 16                                 | CO16T116                       | 30   | -  | 260 | -   | 140 | -  | 4,30                               | 8000         |
| 18                                 | CO16T118                       | 35   | -  | 260 | -   | 140 | -  | 5,97                               | 10000        |
| 6                                  | COC25T106                      | 22   | 13 | 340 | 54  | 180 | 25 | 3,04                               | 1120         |
| 8                                  | COC25T108                      | 22   | 16 | 340 | 70  | 180 | 34 | 3,21                               | 2000         |
| 10                                 | COC25T110                      | 26   | 18 | 340 | 85  | 180 | 40 | 4,58                               | 3150         |
| 13                                 | COC25T113                      | 26   | 20 | 340 | 85  | 180 | 40 | 4,72                               | 5300         |
| 16                                 | COC25T116                      | 30   | 22 | 340 | 115 | 180 | 50 | 6,51                               | 8000         |
| 18                                 | COC25T118                      | 40   | 26 | 340 | 140 | 180 | 65 | 11,81                              | 10000        |

Portate secondo norma EN 818-4  
W.L.L. according to EN 818-4  
W.L.L. selon standard EN 818-4  
Tragfähigkeit gemäß der Norm EN 818-4

CO

**ANELLONI SPECIALI PER GANCI DIN 15401**  
**SPECIAL MASTER LINKS FOR CRANE HOOKS DIN 15401**  
**MAILLON DE TÊTE SPÉCIAUX POUR CROCHET DIN 15401**  
**AUFHÄNGEGLIEDER/AUFHÄNGEKÖPFE FÜR EIFACHKRANHKEN DIN 15401**

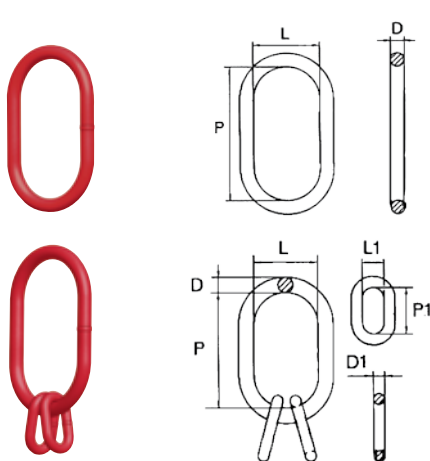

| Catena<br>Chain<br>Chaîne<br>Kette | Codice<br>Code<br>Code<br>Code | Dimensioni secondo DIN 5688-86<br>Size according to DIN 5688-86<br>Dimension selon DIN 5688-86<br>Maß-Tabelle nach DIN 5688-86 |    |     |     |     |    | Peso<br>Weight<br>Poids<br>Gewicht | W.L.L.<br>Kg |
|------------------------------------|--------------------------------|--|----|-----|-----|-----|----|------------------------------------|--------------|
|                                    |                                | D  | D1 | P   | P1  | L   | L1 |                                    |              |
| ∅ mm                               |                                | mm   | mm | mm  | mm  | mm  | mm | Kg                                 | Kg           |
| 6                                  | COCC8T206                      | 18   | 13 | 180 | 54  | 100 | 25 | 1,43                               | 1600         |
| 8                                  | COCC8T208                      | 20   | 16 | 180 | 70  | 100 | 34 | 2,05                               | 2800         |
| 10                                 | CO8T210                        | 22   | -  | 180 | -   | 100 | -  | 1,62                               | 4250         |
| 6                                  | COCC16T206                     | 20   | 13 | 260 | 54  | 140 | 25 | 2,20                               | 1600         |
| 8                                  | COCC16T208                     | 20   | 16 | 260 | 70  | 140 | 34 | 2,56                               | 2800         |
| 10                                 | COCC16T210                     | 26   | 18 | 260 | 85  | 140 | 40 | 4,27                               | 4250         |
| 13                                 | COCC16T213                     | 30   | 20 | 260 | 85  | 140 | 40 | 5,68                               | 7500         |
| 16                                 | COCC16T216                     | 35   | 22 | 260 | 115 | 140 | 50 | 8,10                               | 11200        |
| 6                                  | COCC25T206                     | 22   | 13 | 340 | 54  | 180 | 25 | 3,22                               | 1600         |
| 8                                  | COCC25T208                     | 22   | 16 | 340 | 70  | 180 | 34 | 3,58                               | 2800         |
| 10                                 | COCC25T210                     | 30   | 18 | 340 | 85  | 180 | 40 | 6,53                               | 4250         |
| 13                                 | COCC25T213                     | 35   | 20 | 340 | 85  | 180 | 40 | 8,90                               | 7500         |
| 16                                 | COCC25T216                     | 40   | 22 | 340 | 115 | 180 | 50 | 12,12                              | 11200        |
| 18                                 | COCC25T218                     | 40   | 26 | 340 | 140 | 180 | 65 | 13,63                              | 14000        |

Portate secondo norma EN 818-4  
W.L.L. according to EN 818-4  
W.L.L. selon standard EN 818-4  
Tragfähigkeit gemäß der Norm EN 818-4

CO

**ANELLONI SPECIALI PER GANCI DIN 15401**  
**SPECIAL MASTER LINKS FOR CRANE HOOKS DIN 15401**  
**MAILLON DE TÊTE SPÉCIAUX POUR CROCHET DIN 15401**  
**AUFHÄNGEGLIEDER/AUFHÄNGEKÖPFE FÜR EIFACHKRANHKEN DIN 15401**

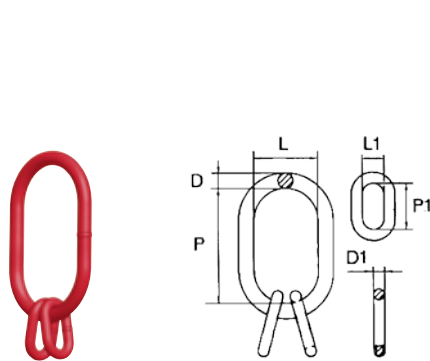

| Catena<br>Chain<br>Chaîne<br>Kette | Codice<br>Code<br>Code<br>Code | Dimensioni secondo DIN 5688-86<br>Size according to DIN 5688-86<br>Dimension selon DIN 5688-86<br>Maß-Tabelle nach DIN 5688-86 |    |     |     |     |    | Peso<br>Weight<br>Poids<br>Gewicht | W.L.L.<br>Kg |
|------------------------------------|--------------------------------|--|----|-----|-----|-----|----|------------------------------------|--------------|
|                                    |                                | D  | D1 | P   | P1  | L   | L1 |                                    |              |
| ∅ mm                               |                                | mm   | mm | mm  | mm  | mm  | mm | Kg                                 | Kg           |
| 6                                  | COCC8T306                      | 20   | 13 | 180 | 54  | 100 | 25 | 1,70                               | 2360         |
| 8                                  | COCC8T308                      | 22   | 16 | 180 | 70  | 100 | 34 | 2,35                               | 4250         |
| 6                                  | COCC16T306                     | 22   | 13 | 260 | 54  | 140 | 25 | 2,61                               | 2360         |
| 8                                  | COCC16T308                     | 26   | 18 | 260 | 85  | 140 | 40 | 4,27                               | 4250         |
| 10                                 | COCC16T310                     | 30   | 18 | 260 | 85  | 140 | 40 | 5,39                               | 6700         |
| 13                                 | COCC16T313                     | 35   | 22 | 260 | 115 | 140 | 50 | 8,10                               | 11200        |
| 6                                  | COCC25T306                     | 22   | 13 | 340 | 54  | 180 | 25 | 3,22                               | 2360         |
| 8                                  | COCC25T308                     | 30   | 18 | 340 | 85  | 180 | 40 | 6,53                               | 4250         |
| 10                                 | COCC25T310                     | 30   | 18 | 340 | 85  | 180 | 40 | 6,53                               | 6700         |
| 13                                 | COCC25T313                     | 40   | 22 | 340 | 115 | 180 | 50 | 12,12                              | 11200        |
| 16                                 | COCC25T316                     | 40   | 26 | 340 | 140 | 180 | 65 | 13,63                              | 17000        |

Portate secondo norma EN 818-4  
W.L.L. according to EN 818-4  
W.L.L. selon standard EN 818-4  
Tragfähigkeit gemäß der Norm EN 818-4